

# F-700BL

## FAIL SECURE ELECTRIC BOLT LOCK

### Product Features



- **Fail-secure mechanism:** the lock remains locked when power is lost, which is key safety feature for security restricted areas.
- **Durable Construction:** it features an all metal construction with 304 stainless steel solid bolt providing a high holding force.
- **Low Temperature Operation:** The lock is designed with special photoelectric control and low-power consumption technology that keeps the device at a low temperature during operation, enhancing its lifespan and safety.
- **Low Power Consumption:** The lock includes signals for both the door status (open/close) and the lock status (locked/unlocked) NO, NC, COMM outputs
- **Time delay.** it offers an adjustable auto-lock time delay of 0, 3, 6 and 9 seconds
- **Wide Temperature Range:** It can operate in extreme temperatures ranging from -10°C to 55°C

### Technical Specification

Model	F-700BL
Material	Superior Strength Aluminium Alloy, Solid Stainless Steel Bolt.
Face plate material	Stainless Steel
Voltage	DC12V±10%
Start / Standby Current	1000mA / 90mA
Bolt Type	Solid Bolt with polished housing, 2000Kg/4409lb Holding Force
Suitable Door Type	Wooden Door, Glass Door, Metal Door, Fireproof Door
Signal Output	Lock signal(NO/NC/COM); Door signal: NO/COM
LED	Light on indicates locked, light off indicates unlocked
Operating humidity	0~90%(non-condensing)
Operating Temperature	-10°C~55°C(14F~131F)
Mechanical Life	Tested to 500000 operations
Induction Distance	Within 8mm/0.31in
Bolt	16(diameter)(mm) / 0.63(prolongation)*0.63(diameter)(in)
Lock Body Dimension	215Lx35Wx38H(mm) / 8.5Lx1.4Wx1.5H(in)
Magnetic Plate Dimension	100Lx25Wx2.5H(mm) / 3.9Lx1Wx0.1H(in)
Weight	0.9KG

## Dimensions:

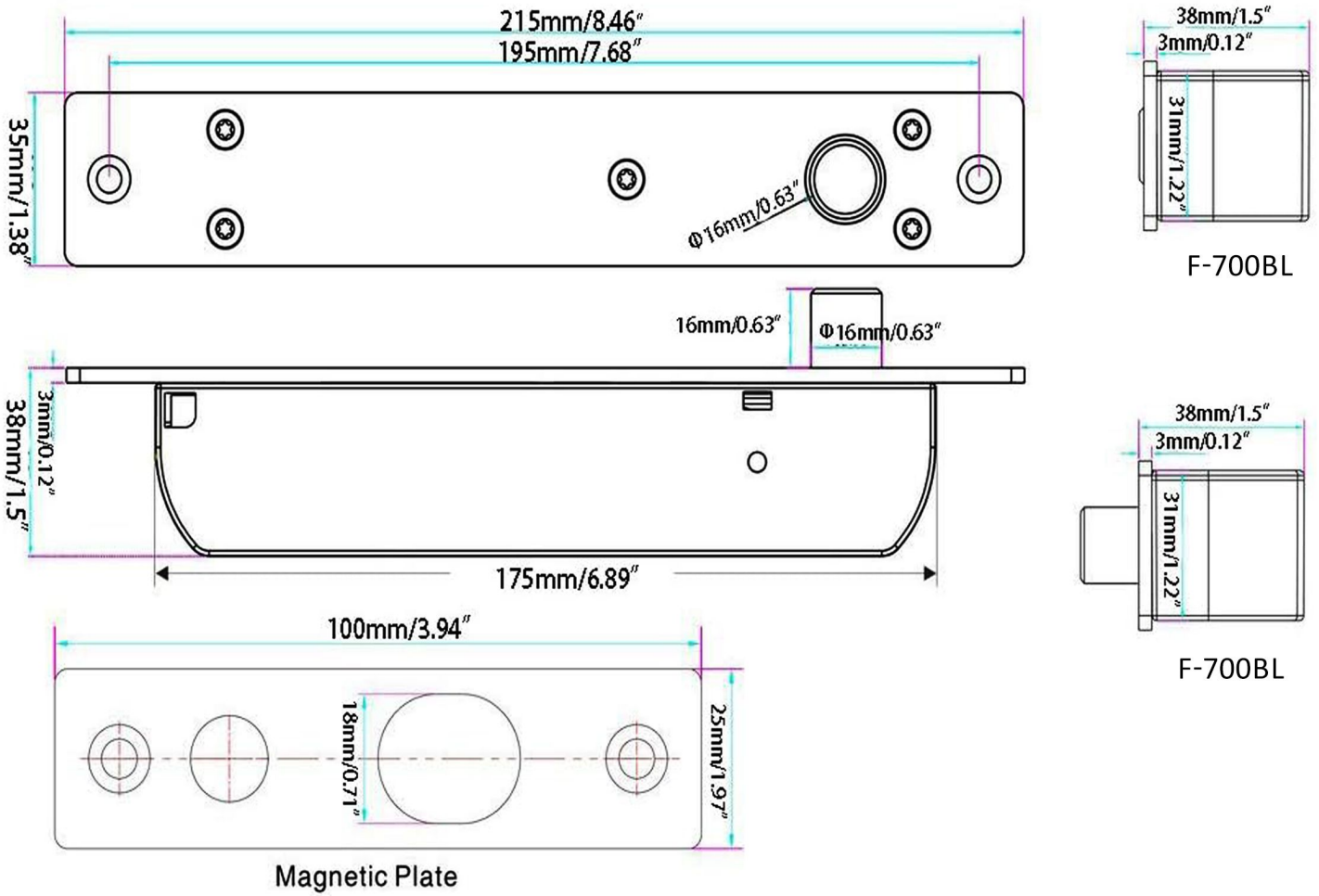

## Connection details:

### Timer Delay Adjustment

Adjust the delay time for locking automatically  
0/3/6/9 secs.

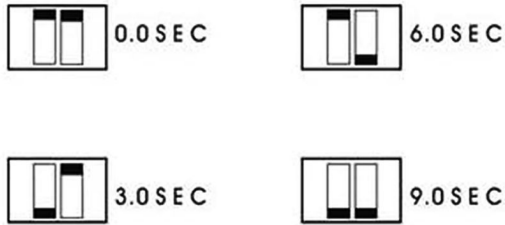

### Complete Wiring Diagram

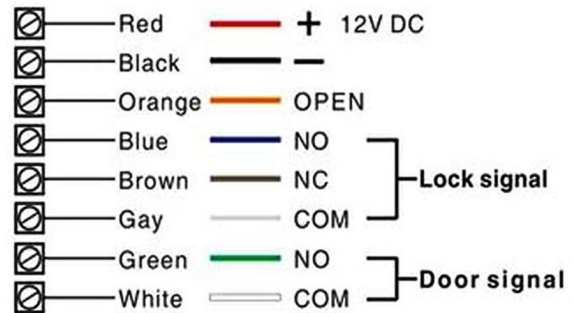

### Installation Schematic

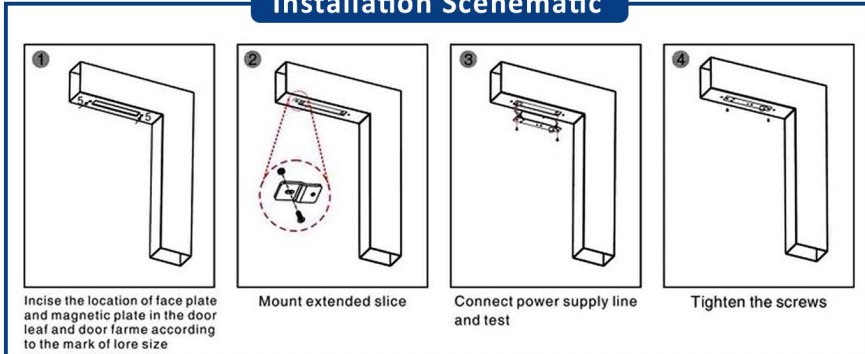

### Mounting Schematic

